

SerieR

V16/18
V22
V25
V30

F22
F28

R32
R40
R45

TCS
DIGIT
AUTOMAX

VFRHT

S E R I E



R32
R32E
R40
R40E
R45



SERRMAC
growing in motion

R32

Medium-size drilling machine with high performance transmission



Automatic mechanical
quill-feed



TR: 600 x 345 mm
Rectangular table with rack



PGM: 325 x 325 mm
Tilting table with vice and rack



VARIABLE

SERRMAC

CE  MADE IN ITALY

TR

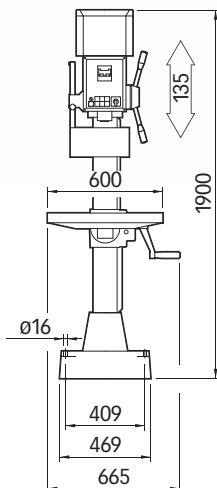
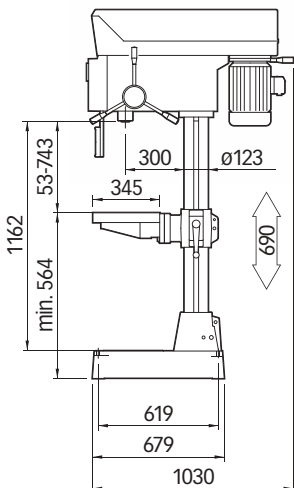

PGM

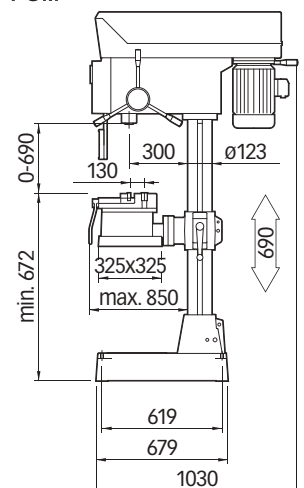

R32E

Medium-size drilling machine
with high performance transmission
and electronic potentiometer



Inverter Easy to set



Automatic mechanical
quill-feed



TR: 600 x 345 mm
Rectangular table with rack



PGM: 325 x 325 mm
Tilting table with vice and rack



VARIABLE

SERRMAC

CE  MADE IN ITALY

TR

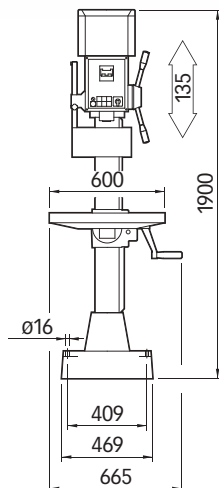
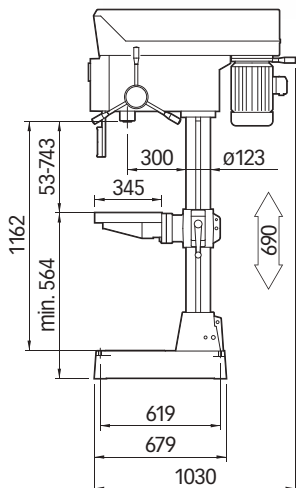

PGM PG

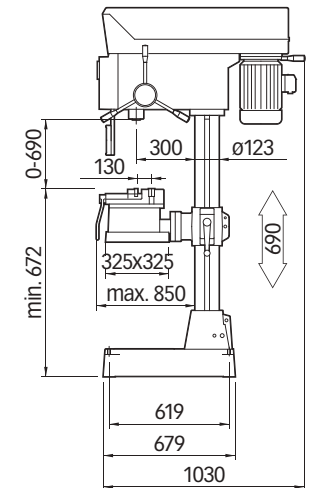

R40

Medium/Heavy-size drilling machine with high performance transmission

Threaded quill nose
for toll fitting MT4

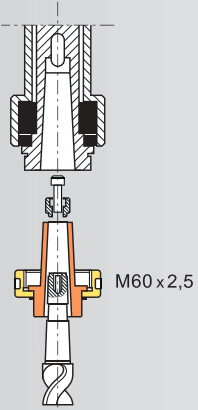

TR: 600 x 345 mm
Rectangular table with rack



PGM: 325 x 325 mm
Tilting table with vice and rack



TC: 630 x 255 mm
Cross table



VARIABLE

SERRMAC

CE  MADE IN ITALY

TR

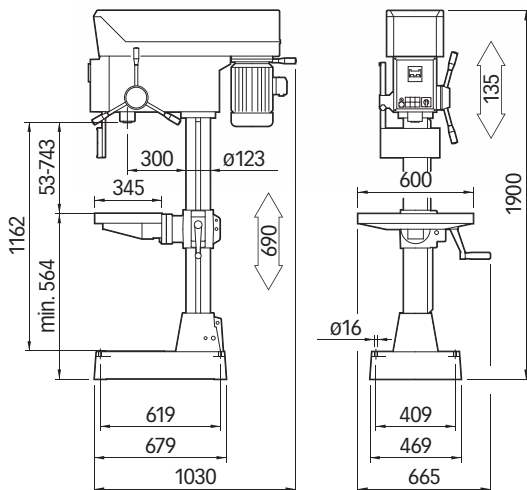

PGM

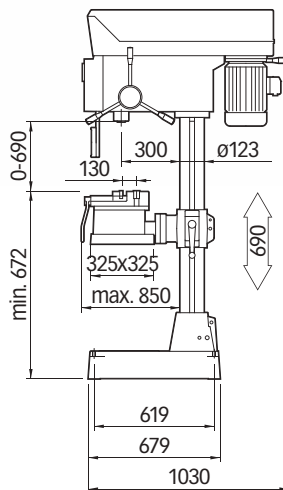

TC

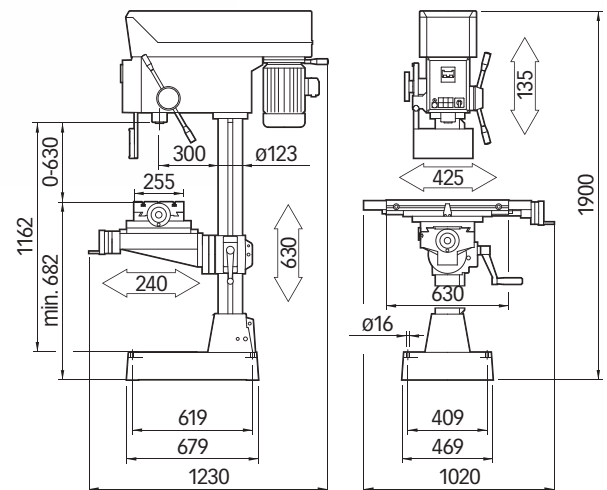

R40E

Medium/ Heavy-size drilling machine
with high performance transmission
and electronic potentiometer



Inverter Easy to set



Threaded quill nose
for toll fitting MT4

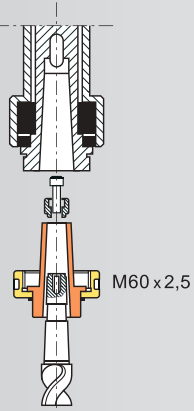

TR: 600 x 345 mm
Rectangular table with rack



PGM: 325 x 325 mm
Tilting table with vice and rack



TC: 630 x 255 mm
Cross table



VARIABLE

SERRMAC

CE MADE IN ITALY

TR

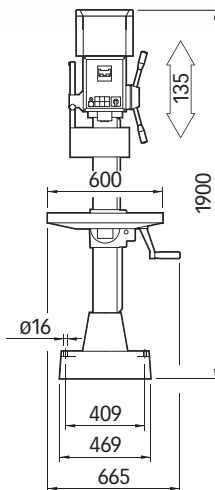
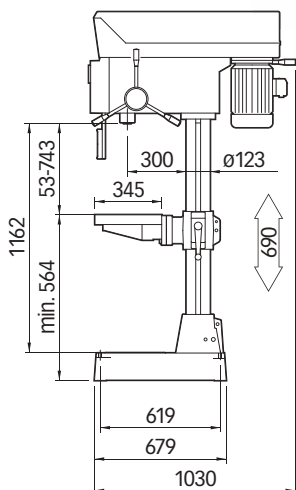

PGM

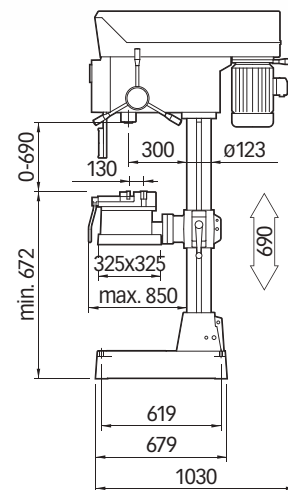

TC

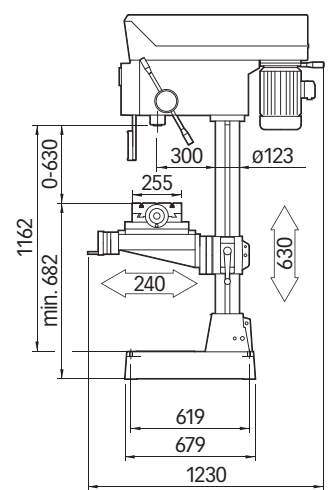
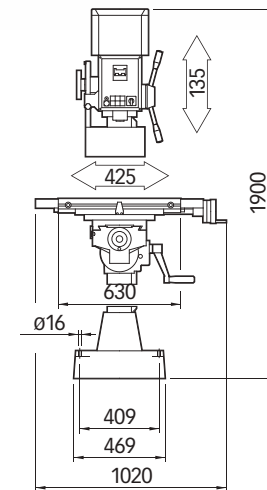

R45

Heavy-size drilling machines

Threaded quill nose
for toll fitting MT4

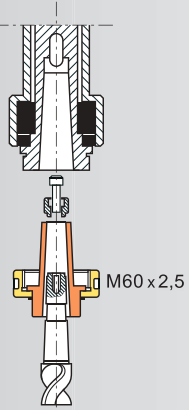

Standard: Automatic
mechanical quill-feed



TR: 600 x 460 mm
Rectangular table with rack



PGM: 375 x 375 mm
Tilting table with vice and rack



TC: 630 x 255 mm
Cross table



VARIABLE

SERRMAC

CE  **MADE IN ITALY**

TR

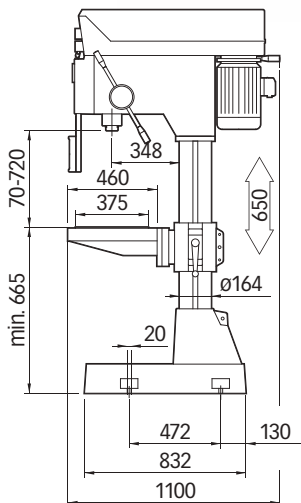

PGM

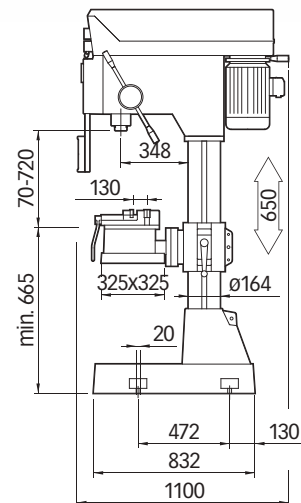

TC

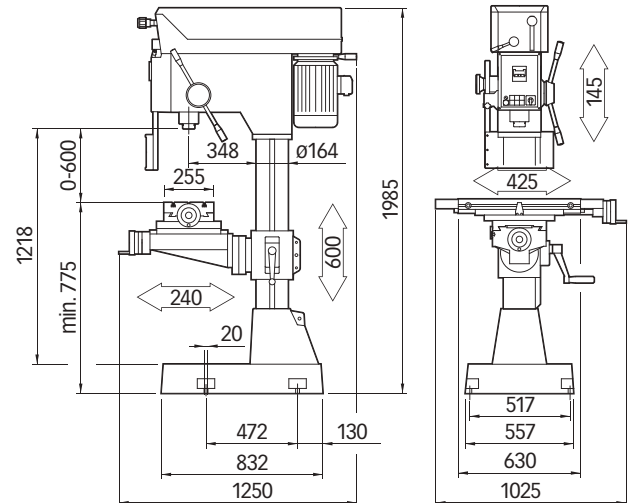

OPTIONS



Code 40022: 24 V LED light



Code 30001: Cooling system

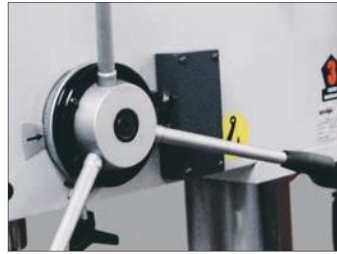

Code 40002: Thread-cutting unit with 24 Volt transformer



Code 40024: Digital speed counter



Code 30018: Flow drill.

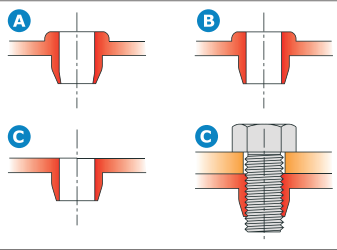
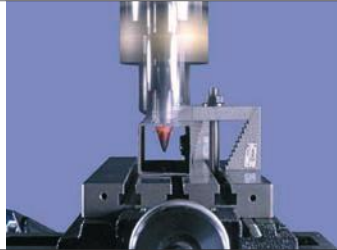

Code 30003: Automatic mechanical quill-feed. 3 speeds: 0,05 – 0,1 – 0,2 mm/rot. (R32 R – 32 R40)



Code 39000050/60/70: Adaptor with locking ring nut for mills MT1 - MT2 - MT3 upon request



Code 39000010/20/30/40: Adaptor with locking ring nut for face-mills attachments on request \varnothing 16–22–27–32.



Code 9460009: Box with MT4 collet-chuck and \varnothing 4–6–8–10–12–16–20 collets.



Code 30019: UR80 Hydro-pneumatic quill-feed (R32 – R 32 R40)

Code 40010: Discesa mandrino idropneumatica UR100 Hydro-pneumatic quill-feed (R45) 105 mm automatic spindle quill-feed with adjustable rapid release feeds. 5÷2.500 mm/min automatic feed. 6 bar-400 Kg thrust power.

R45

OPTIONALS



Code 40083: 24 V Dc Electro-magnetic automatic quill-feed



Code 40025: Read-out system for X and Y axis (together with TC).



Code 40005: Electronic longitudinal cross table-feed for TC 36÷380 mm/min. Rapid feed 3 m/min



Code 40026 Power: Power Mechanical longitudinal cross-table feed



Code 40006: Rapid vertical table feed



Code 40001: 230 mm long sleeve (only with VS).



Code 40020: ISO 40 spindle including tie-rod .



Code 40037: MT4 Drilled spindle axis for tie rod.

SerieR

		R32		R32E	R40				R40E	R45						
TECHNICAL DATA	Drilling capacity on R50 steel	mm	ø 32		ø 32	ø 40				ø 40	ø 45					
	Tapping capacity on R50 steel	mm	M 20		M 20	M 24				M 24	M 26					
	Spindle-intake		MT3		MT3	MT4				MT4	MT4					
	Quill-stroke	mm	135		135	135				135	145					
	Spindle-quill diameter	mm	62		62	62				62	72					
	Automatic mechanical quill – feed (option)		3 speeds: 0.05 – 0.1 – 0.2 mm/rot.													
	Electro-magnetic automatical quill feed		–		–	–				–	3 speeds: 0.05 – 0.1 – 0.2 mm/rot.					
	Column diameter	mm	123		123	123				123	164					
	Table		PGM – TR		PGM – TR	PGM – TR – TC				PGM – TR – TC	PGM – TR – TC					
	Transmission		PU	VS	Electronic potentiometer	PU	VS	VR	CI	Electronic potentiometer	VS	VR*	CI* N° 12 Sp.			
	Spindle speed	rpm	100 – 2.200		100 – 1.640	100 – 2.000		100 – 2.200	100 – 1.640	*64 – 2.380	64 – 1.720	45 – 900 / 110 - 2150		100 – 1.650	64 – 2.380	50 – 1.300
	Motor Power (380 V 50 Hz)	kW	1.1 – 1.84		2.2	1.1 – 1.84		1.1 – 1.84	2.2	1.1 – 1.84	2.2		2.2 – 3	2.2	2.2 – 3	
	T-slots interaxis (between 2 T-slots)	mm	125		125	125				125	200 (TR) – 160 (TM)					
	T-slots dimension width	mm	14		14	14				14	14					
	Cross table longitudinal stroke- X axis (manual feed)	mm	–		–	425				425	425					
	Cross table longitudinal stroke- X axis (automatic feed)	mm	–		–	365				365	365					
	Cross table transversal stroke- y axis (manual feed)	mm	–		–	240				240	240					
Column model dimensions (h x l x d)	mm	1.900 x 665 x 1.030		1.900 x 665 x 1.030	1.900 x 665 x 1.030				1.900 x 1.020 x 1.230 (TC)	1.986 x 675 x 1.100						
Weight	Kg	370		370	410				410	548 (TR) – 610 (TC)						

* R40 VR option: motor 1.1/1.84 kW - 32/2.380 rpm * R45 VR option: motor 2.2/3 kW - 32/2.380 rpm * R45 CI option: motor 2.2/3 kW - 64/1.720 rpm.

R32 – R32E – R40-R40E

R32 – R40 – R45

R40 – R45

R40 – R45

TRANSMISSION

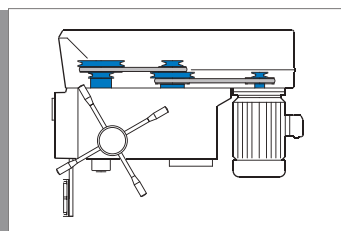

PU: Step pulleys

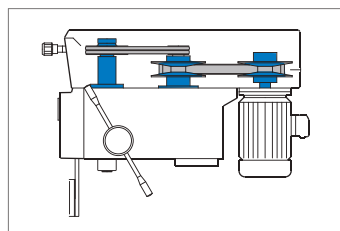

VS: Variable speed-drive unit

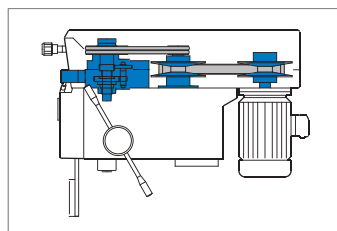

VR: Variable speed-drive unit with gear box

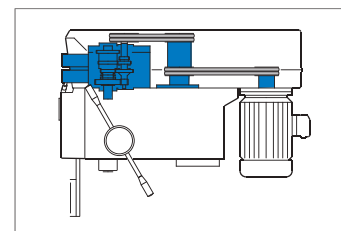

CI: Gear box drive-unit.



VS: Variable speed-drive unit



VR: Variable speed-drive unit with gear box.



CI: Gear box drive-unit

SERRMAC

SERRMAC INTERNATIONAL S.r.l.
Via delle Industrie, 9 - 33070 Polcenigo (PN) - ITALY
Tel. (+39) 0434.671021 - Fax: (+39) 0434.671031
www.serrmac.it - info@serrmac.it



Official dealer